

CURB DETAILS

EN5020 - SINGLE ROOF CURB WITH SUPPORT FRAMING

EN5030 - DOUBLE ROOF CURB

EN5099 - LIGHTWEIGHT ROOF CURB SUPPORT INSTALLATION

EN5100 - LIGHTWEIGHT ROOF CURB



EN5020 - SINGLE ROOF CURB WITH SUPPORT FRAMING

[Download the DWG file by clicking here.](#)

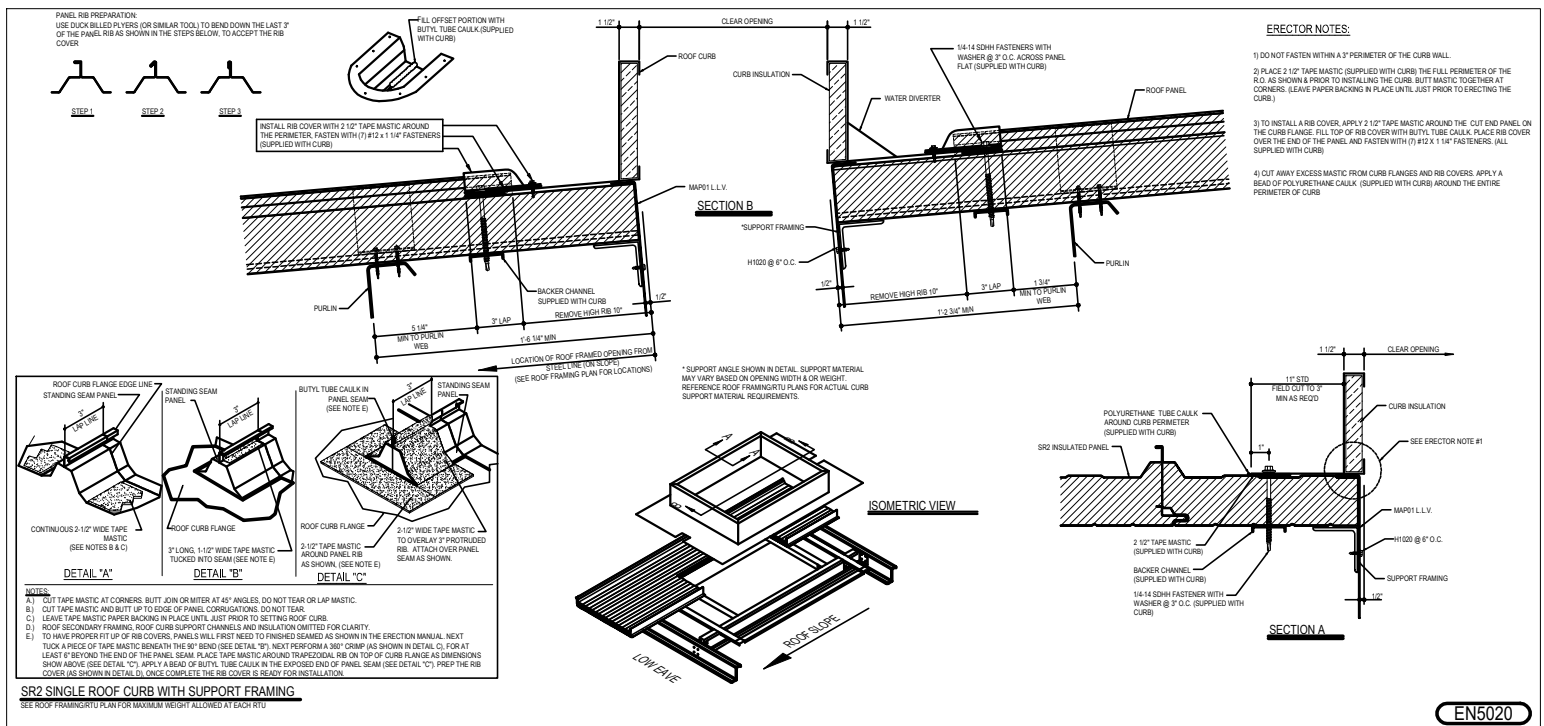



EN5030 - DOUBLE ROOF CURB

Download the DWG file by clicking [here](#).

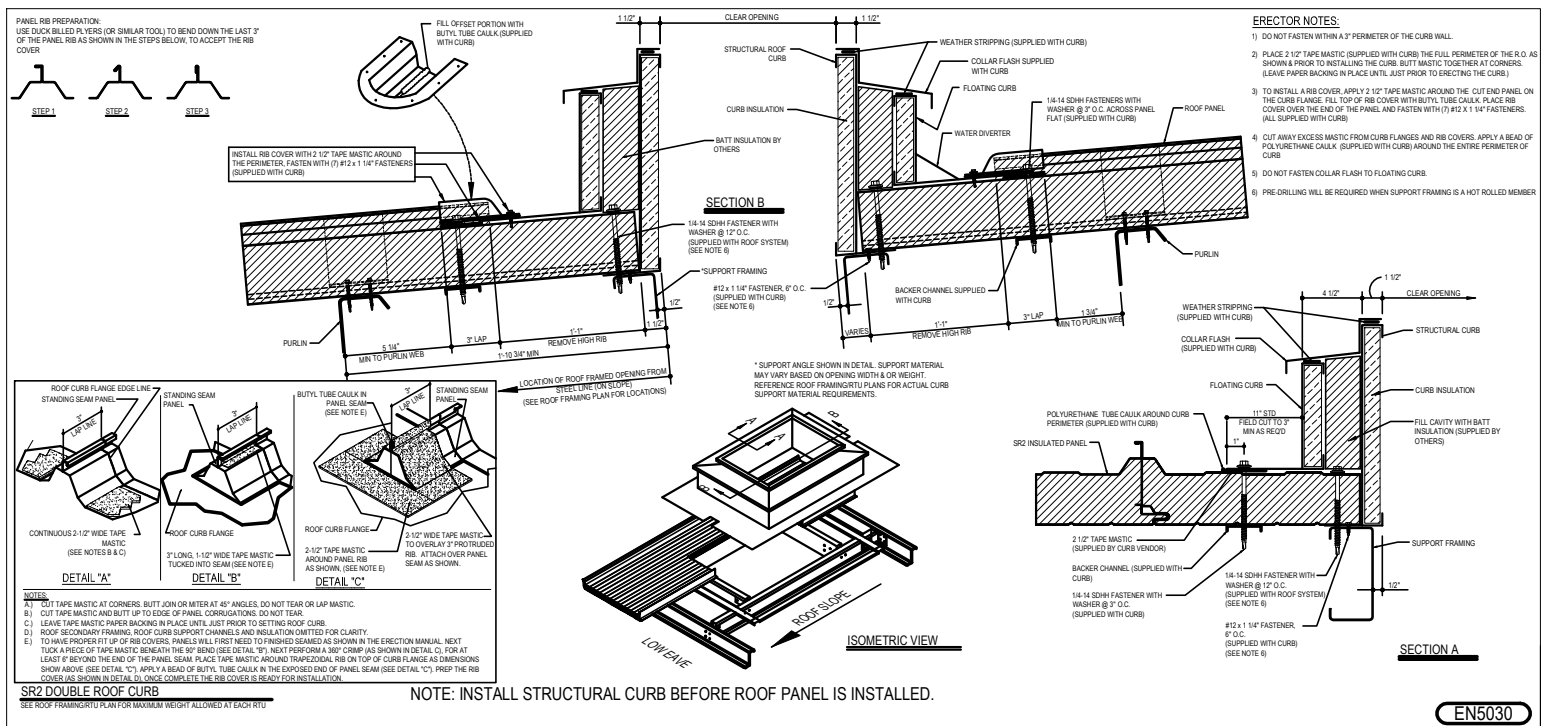



EN5099 - LIGHTWEIGHT ROOF CURB SUPPORT INSTALLATION

[Download the DWG file by clicking here.](#)

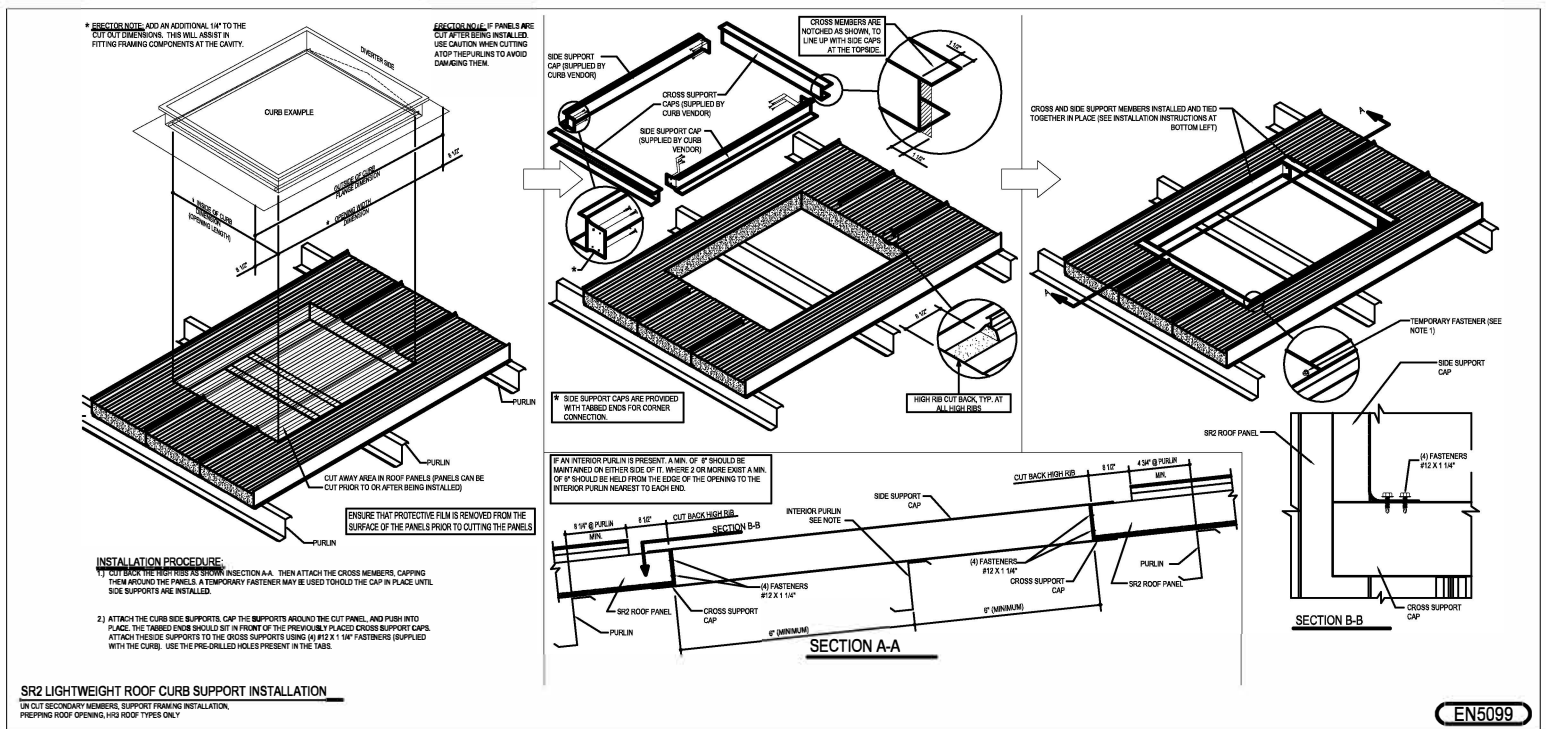



EN5100 - LIGHTWEIGHT ROOF CURB

Download the DWG file by clicking here.

SAFETY PRECAUTION:
WORKERS SHOULD MAINTAIN A CONSTANT AWARENESS OF THEIR LOCATION AND AVOID OPENINGS AT ALL TIMES.

INSTALLATION PROCEDURES:

- 1) REMOVE INSULATION UNDER RIDGE AND 2" LAP LINE ON THE UPSLOPE AND DOWNSLOPE OF ROOF PANEL EDGES. PLACE CURB OVER OPENING. LINE UP CURB FLANGES WITH 2" LAP LINE. CENTER CURB OVER OPENING (SEE DETAIL "A", MARK PANEL RIB LOCATIONS).
- 2) NOTCH UPPER AND LOWER CURB FLANGES AS REQUIRED. SEE DETAIL "A" FOR DIMENSIONS. DRY-FIT CURB OVER OPENING. CHECK FOR PROPER FIT.
- 3) IF TEMPORARY FASTENERS WERE USED AT THE CORNERS, REMOVE THEM NOW. OTHERWISE OMIT NOTE.
- 4) CLEAN OFF ALL GREASE, OIL, METAL SHAVINGS, ETC. FROM AROUND THE ROOF OPENING AND FROM ROOF CURB UNDERSIDE.
- 5) INSTALL ALL PROPER TAPE MASTICS AROUND PERIMETER OF ROOF OPENING. SEE DETAIL "A" AND NOTES A, B AND C.
- 6) AFTER TAPE MASTIC SPANBERA IS REMOVED, CAREFULLY SET CURB OVER OPENING. ALIGN AND FASTEN WITH 1/4"-14 SDH ROOF FASTENERS IN PRE-DRILLED FLANGE HOLES AND EVERY 3'.
- 7) PRIOR TO CURB COVER INSTALLATION, REVIEW NOTE: SEE DETAIL "B", "C", "E" FOR PROPER PLACEMENT OF TAPE MASTIC/TUBE CAULK. PLACE COVER OVER PANEL RIB. LINE UP WITH EDGE OF CURB FLANGE. PUSH DOWN FIRMLY. FASTEN CURB COVER WITH (B) FASTENERS AROUND PERIMETER.
- 8) AFTER ALL ROOF CURB COMPONENTS HAVE BEEN INSTALLED, WAX SURF AREA AROUND ENTIRE ROOF CURB PERIMETER (INCLUDING RIB COVERS) IS CLEAR OF OBSTACLES, OIL, METAL SHAVINGS, ETC. AS NECESSARY, TRIM AWAY EXCESS TAPE MASTIC OR TUBE CAULK FROM AROUND CURB COVERS.
- 9) CUT AWAY EXCESS MASTIC FROM CURB FLANGES AND RIB COVERS. APPLY A BEAD OF POLYURETHANE CAULK (SUPPLIED WITH CURB) AROUND THE ENTIRE PERIMETER OF CURB.
- 10) ATTACH HOLD DOWN CLIPS AT ALL INTERIOR PURLINS AS SHOWN IN DETAIL "E" BELOW.
- 11) INSTALL ALL PROTECTION SAFETY SCREEN AND DOMED SKYLIGHT AS INSTRUCTED IN DETAILS BELOW.

DETAIL "A"
FIELD NOTCH UPSLOPE AND DOWNSLOPE CURB FLANGES AT CORRUGATION LOCATIONS. DO NOT OVERSIZE NOTCHES. PROPER NOTCHING OF FLANGES IS CRITICAL TO WEA TIGHTNESS.

DETAIL "B"
FIELD NOTCH UPSLOPE AND DOWNSLOPE CURB FLANGES AT CORRUGATION LOCATIONS. DO NOT OVERSIZE NOTCHES. PROPER NOTCHING OF FLANGES IS CRITICAL TO WEA TIGHTNESS.

DETAIL "C"
FIELD NOTCH UPSLOPE AND DOWNSLOPE CURB FLANGES AT CORRUGATION LOCATIONS. DO NOT OVERSIZE NOTCHES. PROPER NOTCHING OF FLANGES IS CRITICAL TO WEA TIGHTNESS.

SECTION A-A
ROOF CURB
FASTENERS #10x14" (LOCATE IN PRE-DRILLED FLANGE HOLES, 3" O.C.)
FASTENERS 1/4"-14 SDH (PROVIDED BY PANEL SUPPLIER) (LOCATE IN PRE-DRILLED FLANGE HOLES, 3" O.C.)
POLYURETHANE TUBE CAULK AROUND CURB PERIMETER (SUPPLIED WITH CURB)
CONTINUOUS 2-1/2" TAPE MASTIC (BOTH SIDES)
ROOF PANEL
CURB SUPPORT CAP (SIDES)

SECTION B-B
1/4"-14 SDH FASTENERS WITH WASHER @ 3" O.C. (AS PER PANEL FLAT (SUPPLIED WITH ROOF SYSTEM))
FASTENERS #12x14" (LOCATE IN PRE-DRILLED FLANGE HOLES, 3" O.C.)
ROOF CURB
POLYURETHANE TUBE CAULK AROUND ROOF CURB PERIMETER COVERS (SUPPLIED WITH CURB)
INTERIOR PURLINS NOT SHOWN FOR CLARITY
CONTINUOUS 2-1/2" TAPE MASTIC (SUPPLIED WITH CURB)
BACKER PLATE SUPPLIED WITH CURB
PURLIN
INSULATED ROOF PANEL
PURLIN
3/4" MIN
1-1/2" MIN

DETAIL "T"
ALL OFFSET PORTION WITH BUTYL TUBE CAULK (SUPPLIED WITH CURB)

DETAIL "T'"
HOLD DOWN CLIP (CENTERED ON TOP OF HT. DIFFERENTIAL CLIP, SUPPLIED CURB)

DETAIL "E"
HT. DIFFERENTIAL CLIP (CENTERED ON TOP OF HT. DIFFERENTIAL CLIP, SUPPLIED CURB)
SIDE SUPPORT CAP (SUPPLIED WITH CURB)
ROOF CURB (SIDES)
FASTENERS PER CLIP #10x14" (SUPPLIED WITH CURB) (PRE-DRILLING MAY BE REQUIRED INTO JOISTS)
PURLIN SHOWN, JOIST SIMILAR

FALL PROTECTION / SAFETY SCREEN INSTALLATION:

- 1) AS REQUIRED, CUT CURB INSULATION TO LENGTH TO FIT AROUND THE INTERIOR PERIMETER OF ROOF CURB.
- 2) PLACE CURB INSULATION INTO BOTTOM CURB SIDES WITH WHITE FACE EXPOSED.
- 3) TREATENY SEAMS WITH WHITE INSULATION TAPE (BY OTHERS).
- 4) INSTALL TAPE MASTIC CONTINUOUS ALONG TOP FLANGE OF CURB.
- 5) PLACE SAFETY SCREEN OVER CURB. DO NOT FULLY SEAT SAFETY SCREEN AT THIS STEP.
- 6) TUCK THE CURB INSULATION INTO CHANNEL OF SAFETY SCREEN.
- 7) FULLY SEAT SAFETY SCREEN TO TOP OF CURB TO NEST INSULATION.

DOMED SKYLIGHT INSTALLATION:

- 1) HANDLE DOMED SKYLIGHT WITH CARE. INSIDE THE INSIDE OF THE UNIT IS CLEAR OF SCREWS THROUGHOUT THE INSTALLATION PROCESS. DO NOT HIT SKYLIGHT FRAME WITH HAMMER OR ANY OTHER KIND OF Mallet, THIS MAY CAUSE THE WELDS TO SPLIT.
- 2) PROPERLY SEWITE DOMED SKYLIGHT FROM FLAT SURFACES DURING STORAGE TO PREVENT HEAT BUILD-UP OR EXCESSIVE INTERNAL TEMPERATURES UNDER THE DOME. OTHERWISE DAMAGE CAN OCCUR TO INTERNAL COMPONENTS.
- 3) CALKING THE TOP SIDE OF THE FALL PROTECTION SAFETY SCREEN IS NOT REQUIRED. AN AIR SEAL TAPE IS PRE-MOUNTED TO THE UNDERSIDE OF THE SKYLIGHT.
- 4) SET DOMED SKYLIGHT OVER PREPARED CURB. MARK G BURE SKYLIGHT IS SQUARE AND EQUALLY SPACED ON ALL FOUR SIDES OF CURB.
- 5) ATTACH SKYLIGHT WITH PROVIDED SCREWS. BE SURE NOT TO DISTORT THE SKYLIGHT FRAME. DRIVE SCREWS JUST INTO TO FLANGE. OVERTIGHTENING MAY CREATE FORCES WHICH MAY CRACK THE SKYLIGHT LENS.

DOMED SKYLIGHT CLEANING:

- 1) WHEN CLEANING LENS, USE ONLY WATER OR WATER WITH MILD SOAP. USE A SOFT FIBER TO MINIMIZE THE SCRUBBING.
- 2) NEVER USE AMMONIA, ALCOHOL, AROMATIC OR PETROLEUM BASED PRODUCTS TO CLEAN LENS. THIS WILL CAUSE DETERIORATION AND/OR CRACKING OF THE LENS AND WILL VOID THE WARRANTY.

LIGHTWEIGHT ROOF CURB INSTALLATION
SR2 ROOF CURB WITH PRISMATIC DOMES AND PRISMATIC SMOKE VENTS ONLY

EN5100